

Lifemeta™ FCS Single-use Filling Needles

The Cobetter Lifemeta™ FCS Single-Use Filling Needle is an economical and unique filling solution for aseptic filling of liquids. The liquid contact portion is made of stainless steel and can withstand gamma irradiation or steam sterilisation, providing a complete solution for final filling and saving the cost and resources required for cleaning verification and validation.



Quality Assurance

- ISO 9001: 2015 Quality Management System
- ISO Class 7 clean zones
- 316L passivated Stainless Steel Needle + Animal Derived Component Free (ADCF) Polysulfone
- Meet the requirement of USP <87> In Vitro Biological Reactivity Test
- Meet the criteria of the USP <88> Biological Reactivity Test for Class VII plasticse
- Aqueous extraction contains <0.25 EU/mL as determined by Limulus Amebocyte Lysate (LAL), USP <85>
- Particulate matter in the product eluent meets the requirements in USP <788> for small volume parenterals
- Can be gamma irradiated at 25-45 kGy in sterile package or can be autoclaved for 90 minutes at 135°C
- Provide Extractables and Leachables Testing Report

Advantage

- Reduced turnaround time and cleaning time
- High speed filling from bottom to top
- Available in a wide range of diameters to suit a wide range of filling volumes
- Controlled bead generation for precise filling volume

Applications

- Liquid injectable drugs
- Pre-freeze-drying of biopharmaceuticals
- High performance drug filling
- Blood products filling
- Vaccine filling

Ordering Information (with hose barb end)

Part No.	Filling Volume *	Qty (pcs/pk)	Dimensions (mm)		
			AΦ	BΦ	CΦ
FCS12L	> 0.5 mL	10	1.2	5.3	10
FCS16L	> 1.5 mL	10	1.6	5.3	10
FCS21L	> 3 mL	10	2.1	5.3	10
FCS30L	> 5 mL	10	3	5.3	10
FCS38R	> 10 mL	10	3.8	8.6	11.2
FCS46R	> 30 mL	10	4.6	8.6	11.2
FCS55R	> 50 mL	10	5.5	8.6	11.2

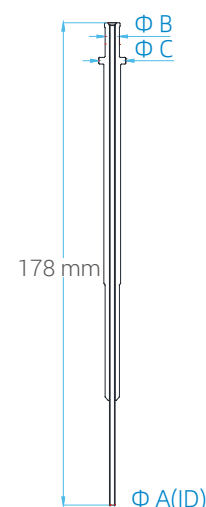

Ordering Information (with straight end)

Part No.	Filling Volume *	Qty (pcs/pk)	Dimensions (mm)		
			AΦ	BΦ	CΦ
FCS16Q	> 1.5 mL	10	1.6	5.3	10

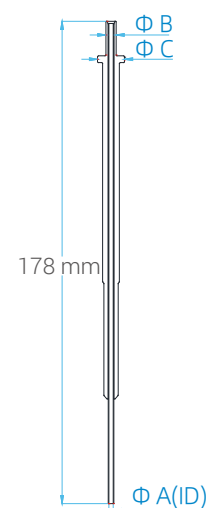

Ordering Information (with hose barb end)

Part No.	Filling Volume *	Qty (pcs/pk)	Dimensions (mm)		
			AΦ	BΦ	CΦ
FCS0620	> 0.1 mL	10	0.6	2	10
FCS4662	> 30 mL	10	4.6	6.2	11.2
FCS1020	> 0.3 mL	10	1	2	10
FCS1217	> 0.5 mL	10	1.2	1.7	10
FCS1621	> 1.5 mL	10	1.6	2.1	10
FCS2128	> 3 mL	10	2.1	2.8	10
FCS3038	> 5 mL	10	3	3.8	10
FCS3846	> 10 mL	10	3.8	4.6	11.2
FCS5562	> 50 mL	10	5.5	6.2	11.2

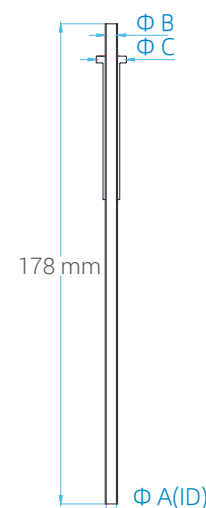

* Filling volume is tested based on pure water, customer solution volume need verify

cobetter®

Please contact us for more information
Hangzhou Cobetter Filtration Equipment Co.,Ltd.

Tel 400-070-4266
 Fax 0571-87704256
 www.cobetter.com

Sales Add 13-18 F, Building 1, Zicheng International Innovation Center, No.39 Jincheng Road, Xiaoshan District, Hangzhou 311215, China
Factory Cobetter Park, Heshang New Material Industry Park, Xiaoshan District, Hangzhou 311265, China

Specifications subject to change without notice.