

# Cobetter Consieve™ SC Spiral Cartridges Technical Data Sheet

Cobetter Consieve™ SC Spiral cartridges are spiral-wound ultrafiltration membrane devices designed for the concentration and buffer change of biopharmaceutical. Cobetter Consieve™ SC Spiral cartridges combine the advantages of efficient tangential flow filtration with Cobetter ultrafiltration (UF) membrane technology to cost-effectively process large volumes of pharmaceutical products.

Based on your process requirements, the cartridges are offered in two ultrafiltration membrane types, regenerated cellulose (RC) and polyethersulfone (PES). RC membranes are Ultra-low protein binding, which means higher yield of target proteins and resistant to fouling and are easy to clean. PES membranes are high flux and compatibility with a wide pH range. All membranes are used in Cobetter cassette form, which are widely used in customer's process. The cartridges are also available in a variety of cut-offs (1-1000kDa).

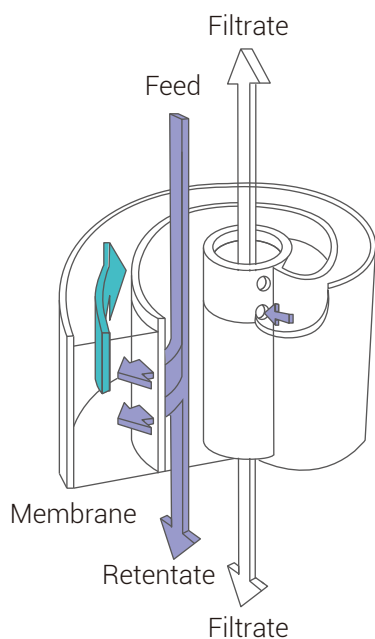

Cobetter Consieve™ SC Spiral cartridges provide reliable filtration and stable hydraulic performance, which are used in a variety of applications, including: concentrating and desalting insulin, heparin sodium, enzymes, biological extracts, viruses, removing pyrogens from solutions of small molecules.

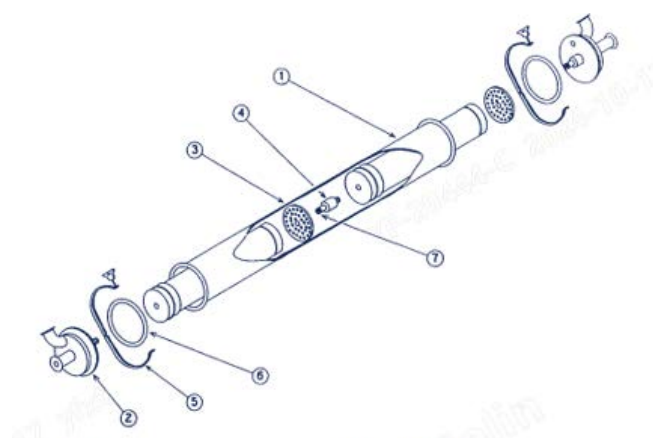

## Materials of Construction

Membrane	Regenerated Cellulose (RC)/Polyethersulfone (PES)
Feed/Retentate Screen	Polyethylene (PE)
Permeate Screen	Polypropylene (PP)
Shell, tube and support disk	Polysulfone (PSF)
Adhesive	Epoxy
Seal and O-rings	EPDM

## Specifications

Length	655mm(25.8in.)
Diameter	96.7mm(3.9in.)
Area	3.7m <sup>2</sup> (40ft <sup>2</sup> )
Cut-off	1/3/5/10/30kDa
pH range	2-12 for RC, 1-14 for PES
Pressure	6.9bar/5000cycles
Operation pressure	3.1bar(TMP)/55-60°C 4.1bar(TMP)/2-8°C
Compatibility (0.1M NaOH)	1bar(TMP)/60°C/400h
Preservative	20% ethanol+20-22% glycerol

## Regulatory Compliance

Cobetter Consieve™ SC Spiral cartridges are designed, developed, and manufactured in accordance with a Quality Management System approved by an accredited registering body to an ISO® 9001 Quality Systems Standard. They are shipped with a Certificate of Analysis. Each cartridge is supported by a Validation Guide for compliance with regulatory requirements. For traceability and easy identification, each cartridge is labeled with the product name and identifying characteristics.

## Cobetter Consieve™ SC Spiral Cartridges

<u>SC</u> Product	<u>UF</u> Application Type	<u>C</u> Membrane	<u>PR</u> Type	<u>001</u> RemoveRating	<u>S</u> Membrane Type	<u>P</u>
<b>SC</b> Cobetter Consieve™ Spiral Cartridges	<b>UF</b> Ultrafiltration	<b>C</b> RC	<b>PR</b> 3.7m <sup>2</sup>	<b>001</b> 1kDa <b>003</b> 3kDa <b>005</b> 5kDa <b>010</b> 10kDa <b>030</b> 30kDa	<b>S</b> Normal <b>L</b> HighFlowRate <b>H</b> High Retention Rate	